

Product Setup Instructions

- Original Twist •
- Easi Link Kit •
- Flexi Link Kit •
- Media Twist •
- 32" Media Twist •
- Flat End Cap •**
- Curved End Cap •
- Twist Counter •
- Double Hardcase Conversion •
- Single Hardcase Conversion •
- Twist Shelf •



Items

Items: 6x magnetic bars, endcap graphic panel, complete double sided **Twist** stand.

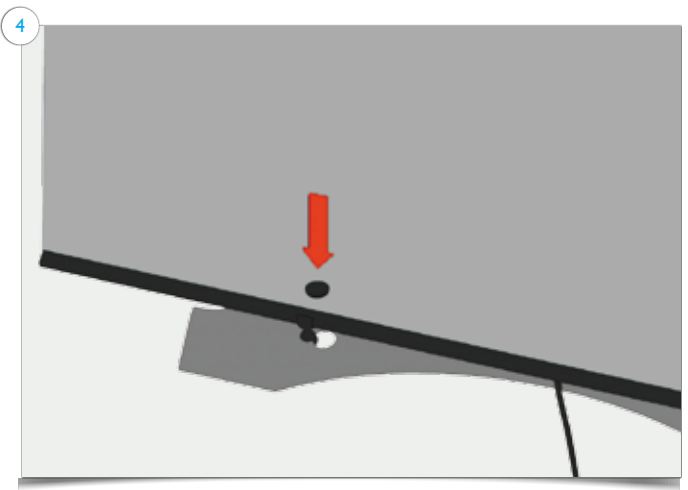
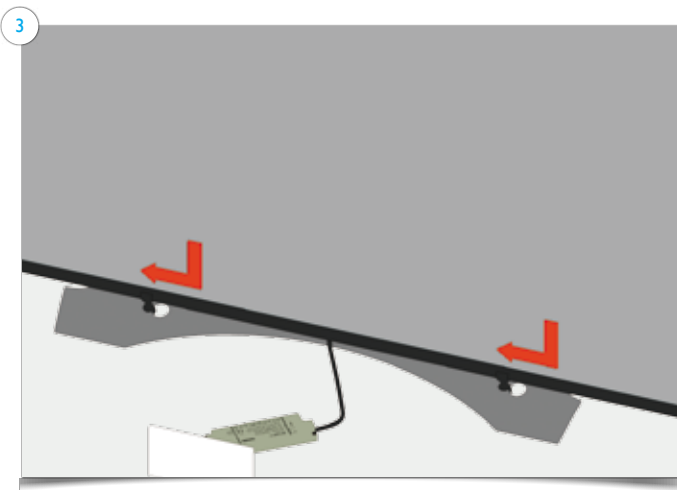
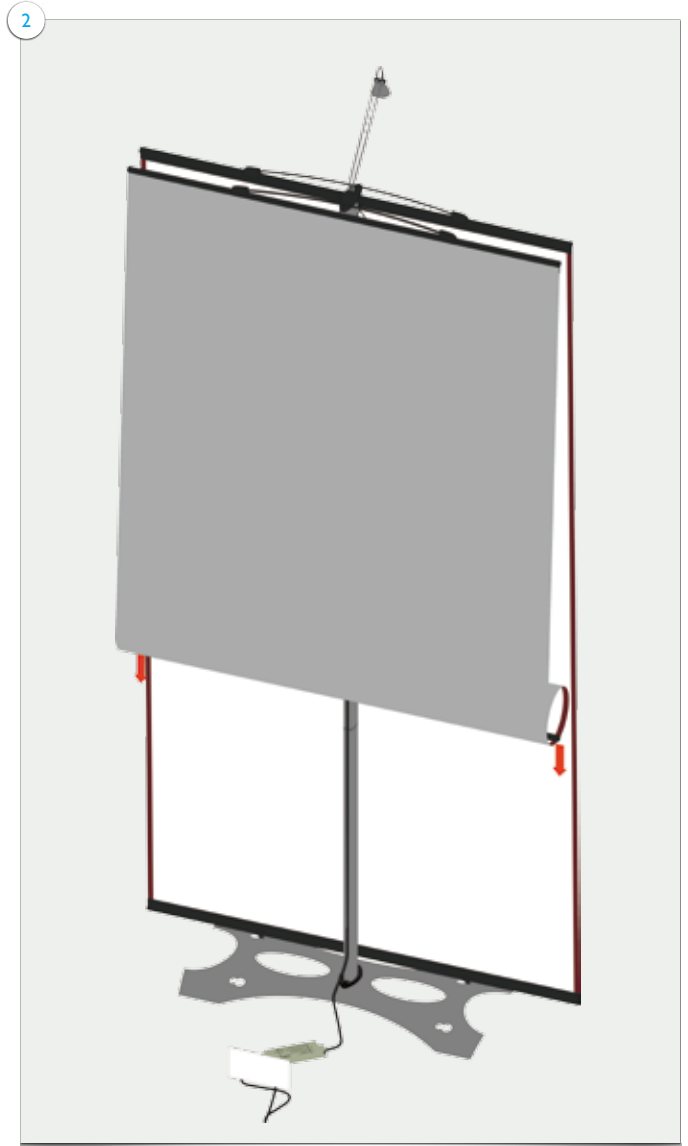
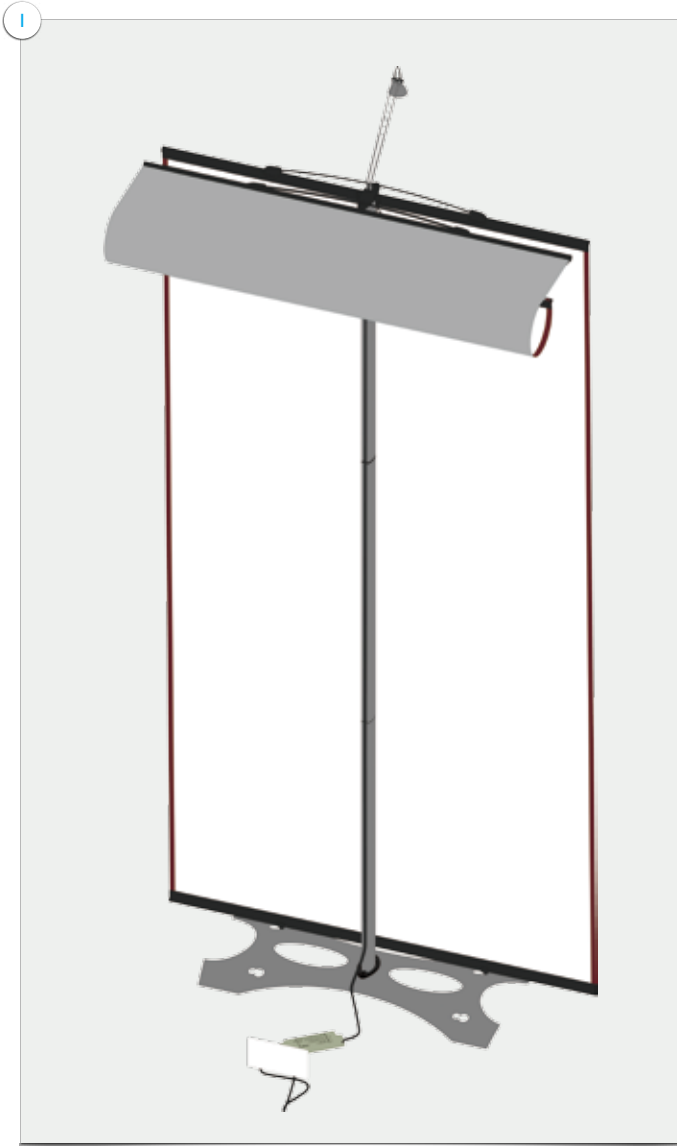

Part2
Flat End Cap Setup Instructions

Attach magnetic bars to **Twist** graphics first, leaving half of magnetic bar showing.

