

Product Setup Instructions

Original Twist •

Easi Link Kit •

Flexi Link Kit •

Media Twist •

32" Media Twist •

Flat End Cap •

Curved End Cap •

Twist Counter •

Double Hardcase Conversion •

Single Hardcase Conversion •

Twist Shelf •



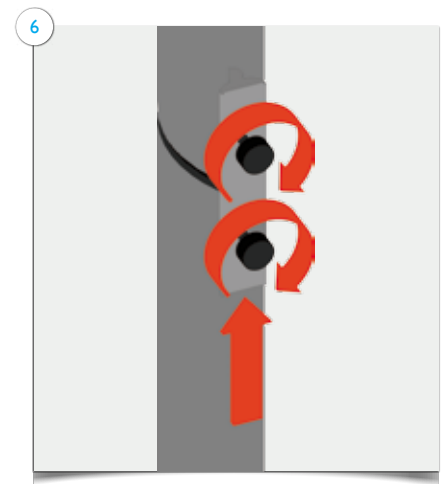
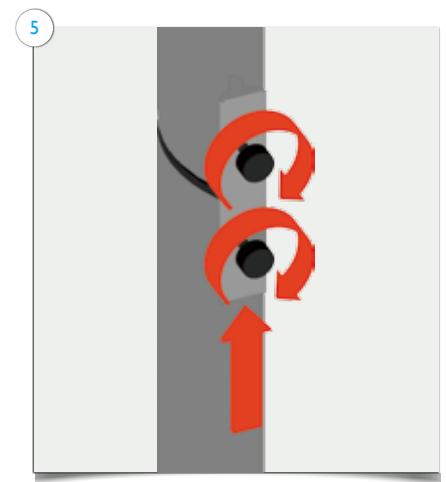
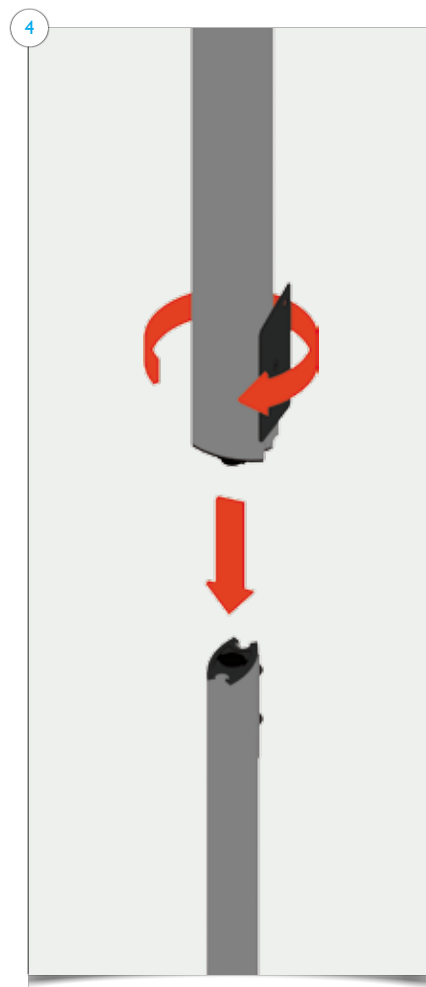
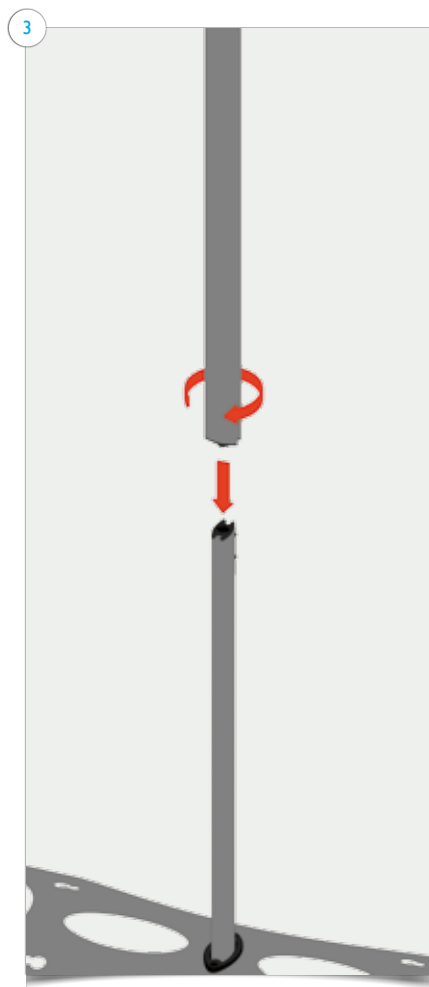
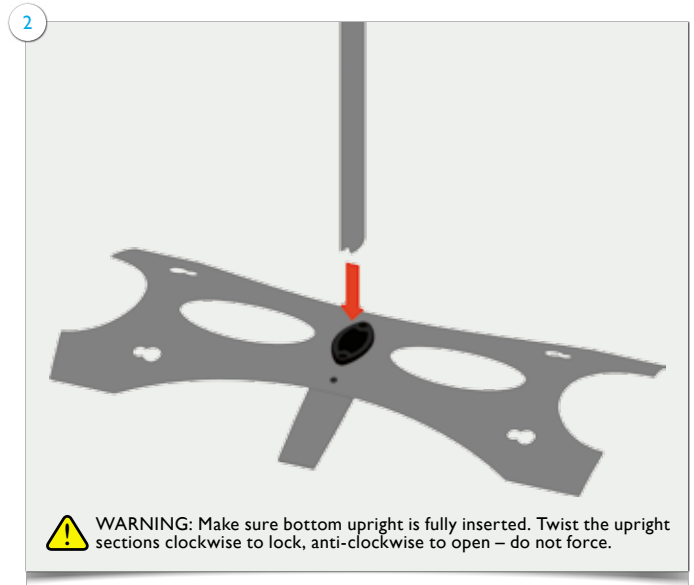
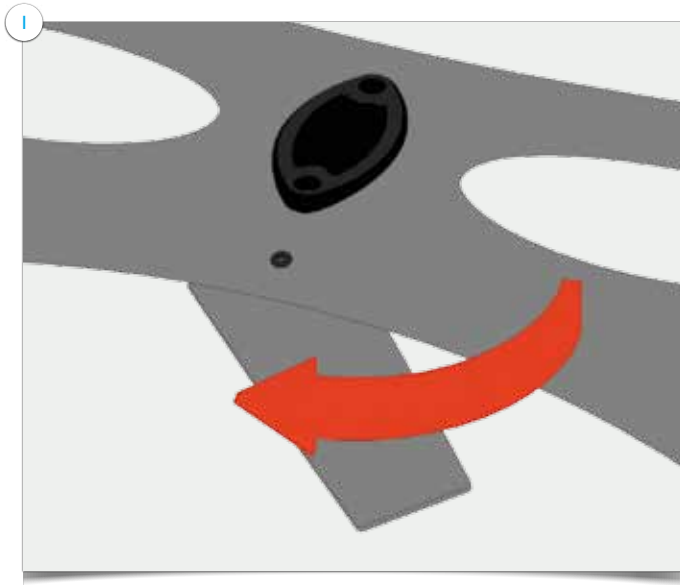

Items

Items: 1x base with stabilizing foot and grommet; 1x bottom upright section; 1x middle upright section; 1x top upright section with media bracket; 1x light; 1x transformer; 1x graphic panel with finishing strips; 2x locking pins; 1x VESA monitor mount; 4x screws; 1x Allen key.

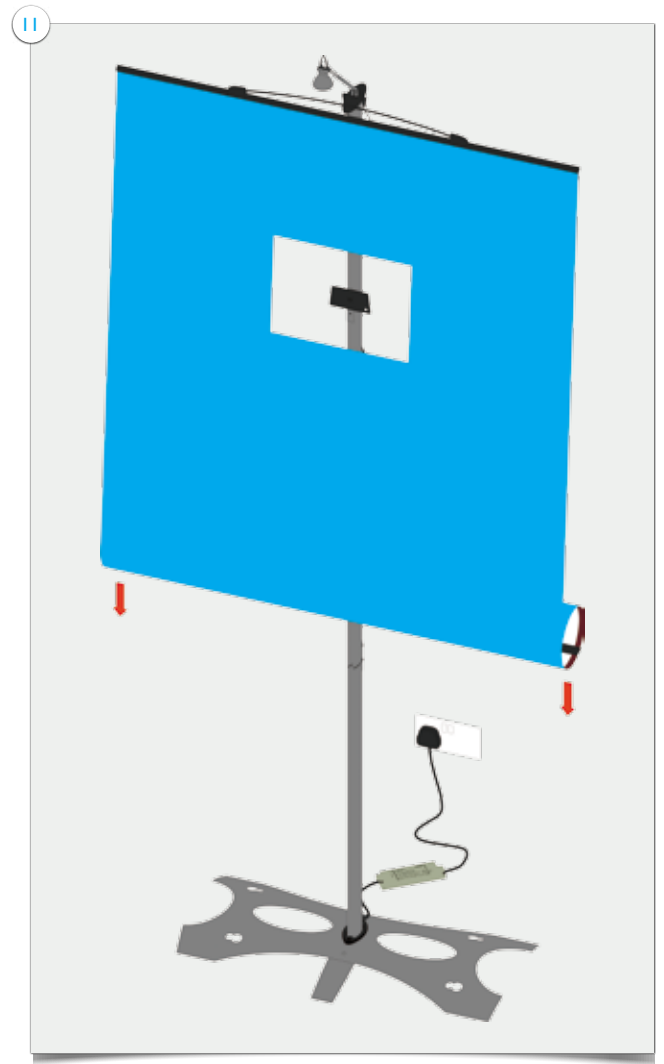
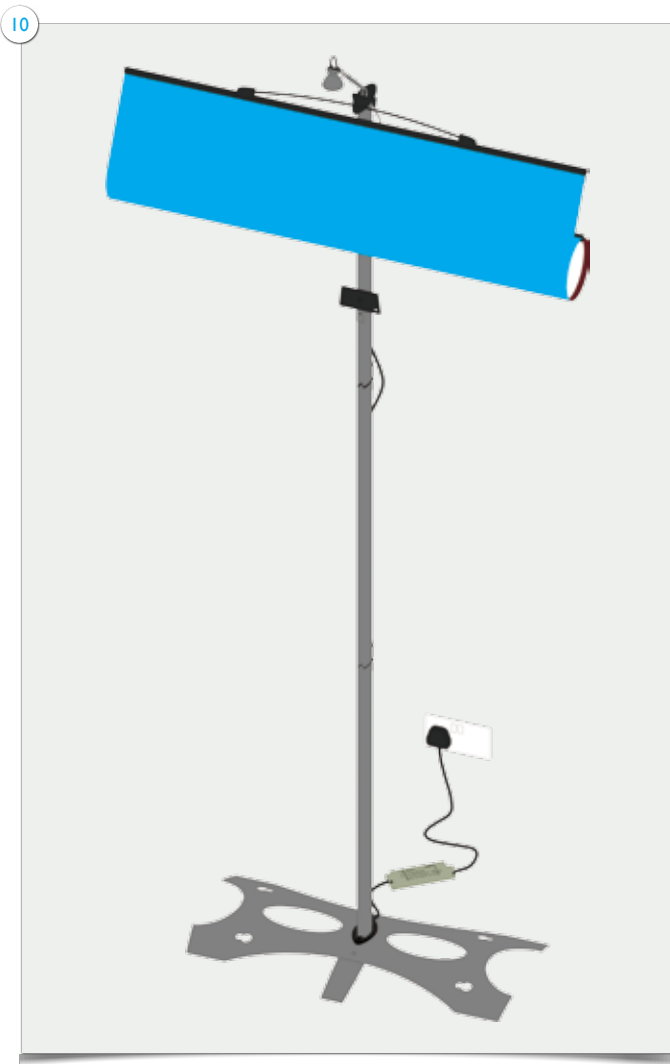
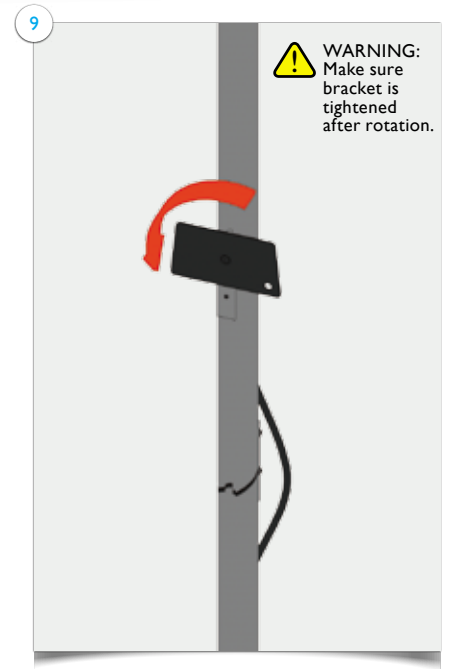
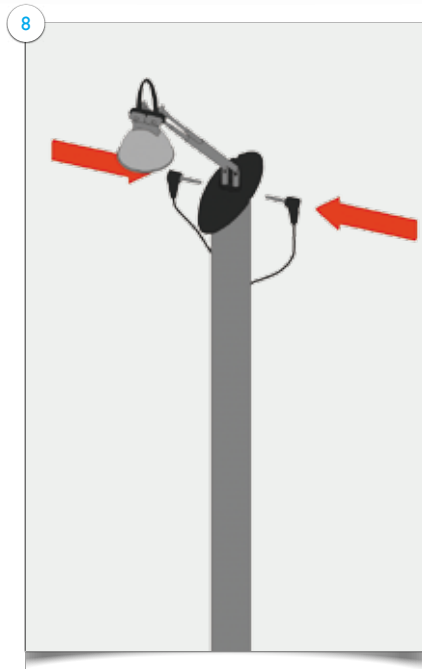
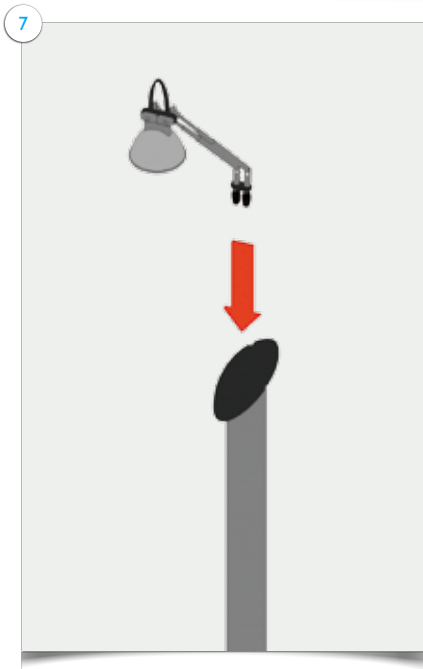

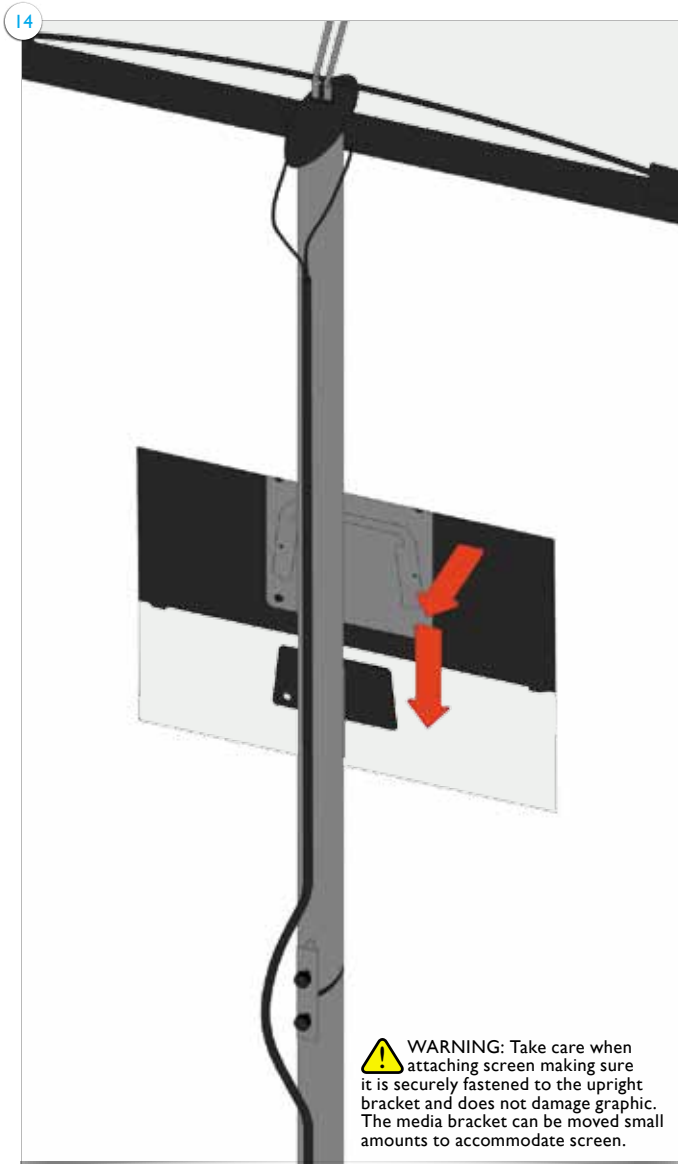
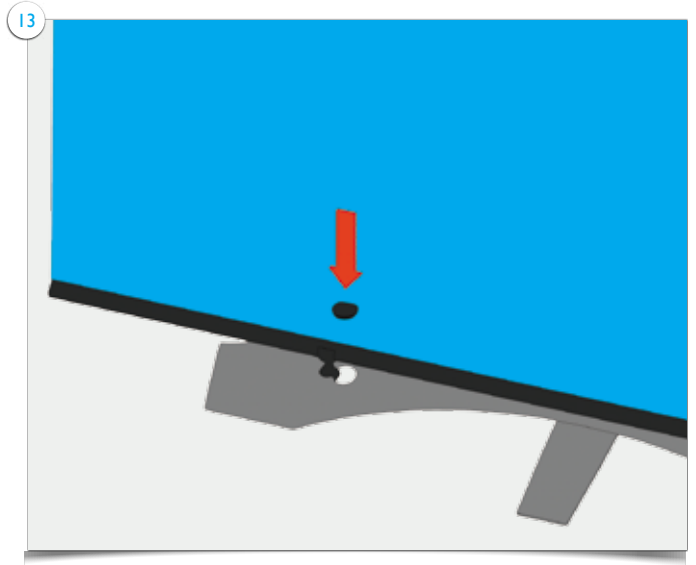
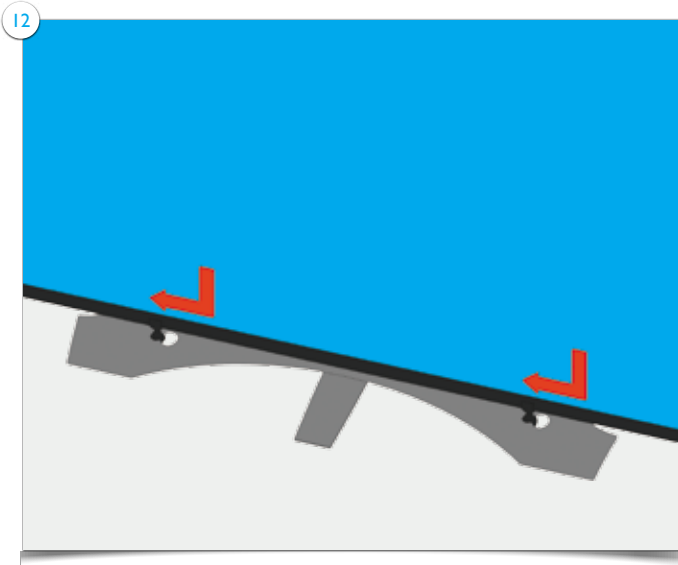



 **WARNING:** Take care when attaching screen making sure it is securely fastened to the upright bracket and does not damage graphic. The media bracket can be moved small amounts to accommodate screen.

